

## ASU Biomedical Knowledge Management Lab

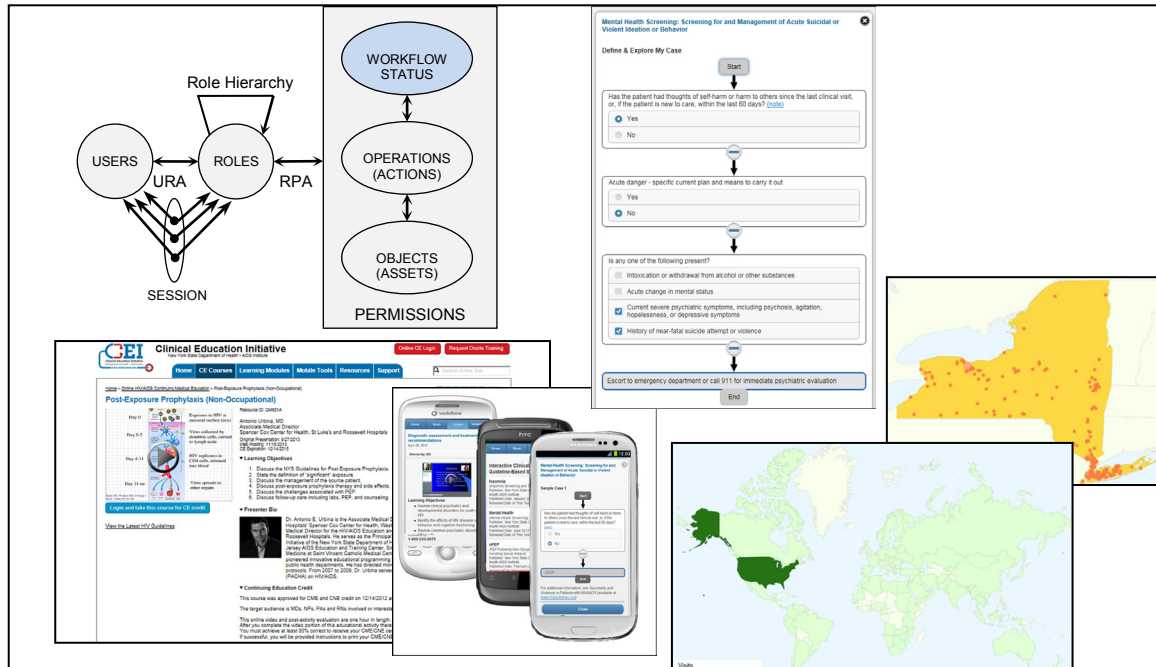

The Biomedical Knowledge Management Lab at ASU engages in research on modeling, representation, and dissemination of biomedical knowledge as well as development and implementation of knowledge-driven information resources, tools, and systems. Specific research topics include: 1) development of computer-based models to represent clinical practice guidelines, healthcare processes, and clinical research protocols; 2) information management in specific context of workflow and team collaboration; and 3) delivery of technology-mediated behavioral interventions to facilitate biomedical knowledge translation, healthcare processes, and patient outcomes. Our works have been applied to address real-world challenges such as improvement of childhood immunization rate, support of post-CABG critical pathway, screening of patients with major depression, assistance of diabetic foot-care, enhancement of visit compliance in ambulatory mental health care, facilitation of subject recruitment and retention for clinical research, and management of HIV/AIDS patients.

### Contact Information

Dongwen Wang, PhD  
Professor of Biomedical Informatics  
Arizona State University

13212 E. Shea Blvd.  
Mayo Clinic, Johnson Research Building, Room 288  
Scottsdale, AZ 85259  
[dongwen.wang@asu.edu](mailto:dongwen.wang@asu.edu)  
480-884-0264